

G**COMPANIES FORM No. 169****Return by a company purchasing its own shares****169**

Pursuant to section 169 of the Companies Act 1985

Please do not
write in
this marginTo the Registrar of Companies
(Address overleaf)

For official use

Company number

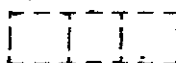
Please complete
legibly, preferably
in black type, or
bold block lettering

3145895

Please do not write
in the space below.
For Inland Revenue
use only.* insert full name
of company

Name of company

* CAPITAL FOR COMPANIES VCT PLC.

NoteThis return must be
delivered to the
Registrar within a
period of 28 days
beginning with the
first date on which
shares to which it
relates were delivered
to the company

Shares were purchased by the company under section 162 of the above Act as follows:

Class of shares	ORDINARY		
Number of shares purchased	48000		
Nominal value of each share	10p		
Date(s) on which the shares were delivered to the company	5/7/03		
Maximum prices paid £ for each share	50p		
Minimum prices paid £ for each share	50p		

§ A private company
is not required to
give this informationThe aggregate amount paid by the company for the shares
to which this return relates was:

£24000.00

Stamp duty payable pursuant to section 66 of the Finance Act
1986 on the aggregate amount at 50p per £100 or part of £100

£ 120.00

£120.00
TR
10051
US
4/8/03† Insert
Director,
Secretary,
Receiver,
Administrator,
Administrative
Receiver or
Receiver
(Scotland) as
appropriate

Signed

Designation†

COMPANY

SECRETARY.

Date 15 July 2003

Presentor's name address and
reference (if any):For official Use
General SectionA31
COMPANIES HOUSE
A20
COMPANIES HOUSE
COMPANIES HOUSE0852
07/08/03
0658
30/07/03
0613
16/07/03