

G

COMPANIES FORM No. 169

Return by a company purchasing its own shares

169

CHFP025

Pursuant to section 169 of the Companies Act 1985

Please do not
write in
this margin

To the Registrar of Companies
(Address overleaf)

For official use

Company number

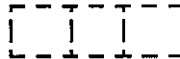

3833128

Please complete
legibly, preferably
in black type, or
bold block lettering

Name of company

Insert full name
of company

* Venturia plc

Note

This return must be
delivered to the
Registrar within a
period of 28 days
beginning with the
first date on which
shares to which it
relates were delivered
to the company

Shares were purchased by the company under section 162 of the above Act as follows:

Class of Shares	Preference		
Number of shares purchased	130,000		
Nominal value of each share	£1.00		
Date(s) on which the shares were delivered to the company	28/1/05		
Maximum prices paid for each share	£1.00		
Minimum prices paid for each share	£1.00		

A private company
is not required to
give this information

The aggregate amount paid by the company for the shares to which this return relates was:

£ 130,000.00

Stamp Duty is payable on the aggregate amount at the rate of 1/2 % rounded up to the nearest multiple of £5

£ 650.00

Insert
Director,
Secretary,
Administrator,
Administrative
Receiver or
Receiver
(Scotland) as
appropriate

Signed  Designation \dagger Director

Date 28/1/05

Presentor's name address and
reference (if any):

Berg & Co (Ref: RM.3991.2)
Scottish Mutual House
35 Peter Street
Manchester
M2 5BG
14379 Manchester 1

For official Use
General Section



A24
COMPANIES HOUSE

0463
09/02/05

