

**Return by a company purchasing
its own shares****169**

CHFP025

Pursuant to section 169 of the Companies Act 1985

Please do not
write in
this marginTo the Registrar of Companies
(Address overleaf)

For official use

Company number

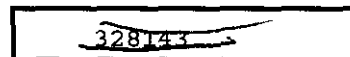
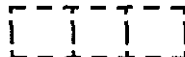
**Please complete
legibly, preferably
in black type, or
bold block lettering**

Name of company

* Beech View Holdings Limited

* insert full name
of company**Note**This return must be
delivered to the
Registrar within a
period of 28 days
beginning with the
first date on which
shares to which it
relates were delivered
to the companyShares were purchased by the company under section 162 of the above Act as
follows:

Class of Shares	Preferred		
Number of shares purchased	13,000		
Nominal value of each share	£1		
Date(s) on which the shares were delivered to the company	31.10.2001		
Maximum prices paid for each share	£		
Minimum prices paid for each share	£		

‡ A private company
is not required to
give this informationThe aggregate amount paid by the company for the shares
to which this return relates was:

£ 13,000.00

Stamp Duty is payable on the aggregate amount at the rate
of 1/2% rounded up to the nearest multiple of £5

£ 65.00

‡ Insert
Director,
Secretary,
Administrator,
Administrative
Receiver or
Receiver
(Scotland) as
appropriate

Signed

Designation ‡ Secretary

Date 1 November 2001

Presentor's name address and
reference (if any):For official Use
General Section

Post room

A43
COMPANIES HOUSE

A9AGZ5FS

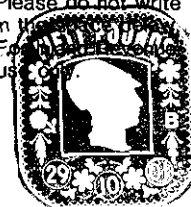
0287
02/11/01Please do not write
in this
marginTR (PO)
CDH
29/10