

G

COMPANIES FORM No. 169

Return by a company purchasing its own shares

CHA 116

Pursuant to section 169 of the Companies Act 1985



169

Please do not write in this margin

To the Registrar of Companies

For official use — company number

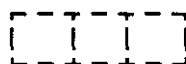

2974633

Please do not write in the space below. For Inland Revenue use only.

Please complete legibly, preferably in black type, or bold block lettering

* insert full name of company

Name of company

* GARTMORE FLEODGLING INDEX TRUST PLC

This return must be delivered to the Registrar within a period of 28 days beginning with the first date on which shares to which it relates were delivered to the company

Shares were purchased by the company under section 162 of the above Act as follows:

Class of Shares	ORDINARY		
Number of shares purchased	25,000		
Nominal value of each share	0.25p		
Date(s) on which the shares were delivered to the company	7/12/99		
Maximum prices paid for each share	£ 1.45p		
Minimum prices paid for each share	£		

‡ A private company is not required to give this information

The aggregate amount paid by the company for the shares to which this return relates was:

£36,250

Stamp duty payable pursuant to section 66 of the Finance Act 1986 on the aggregate amount at 50p per £100 or part of £100

£181.50

‡ Insert Director, Secretary, Receiver, Administrator, Administrative Receiver or Receiver (Scotland) as appropriate

Signed

For and on behalf of
GARTMORE INVESTMENT LTD.

Designation

Date 3/12/99

Presentor's name address and reference (if any):

For official Use
General Section

Post room



A33
COMPANIES HOUSE

0582
10/12/99