

G

COMPANIES FORM No. 169

Return by a company purchasing its own shares

169

CHA 116

Pursuant to section 169 of the Companies Act 1985

Please do not
write in
this margin

To the Registrar of Companies

For official use

Company number

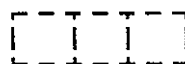

02974633

Please complete
legibly, preferably
in black type, or
bold block lettering* insert full name
of company

Name of company

* GARTMORE FLEDGLING INDEX TRUST PLC

This return must be
delivered to the
Registrar within a
period of 28 days
beginning with the
first date on which
shares to which it
relates were delivered
to the company

Shares were purchased by the company under section 162 of the above Act as follows:

Class of Shares	ORDINARY		
Number of shares purchased	400,000		
Nominal value of each share	25P		
Date(s) on which the shares were delivered to the company	30.12.98		
Maximum prices paid for each share	\$ 81.0p		
Minimum prices paid for each share	\$ 77.0p		

§ A private company
is not required to
give this informationThe aggregate amount paid by the company for the shares
to which this return relates was:

£ 318,000.00

Stamp duty payable pursuant to section 66 of the Finance Act
1986 on the aggregate amount at 50p per £100 or part of £100

£ 1,590.00

† Insert
Director,
Secretary,
Receiver,
Administrator,
Administrative
Receiver or
Receiver
(Scotland) as
appropriate

Signed

Designation † SECRETARIES

Date 30.12.98

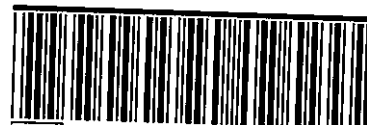
Presenter's name address and
reference (if any):For official Use
General SectA31 *AHH15DKB* 633
COMPANIES HOUSE 04/02/99
COMPANIES HOUSE 09/01/99