

# M

COMPANIES FORM No. 395

SC 000037

£10.00

# 395

CHFP000

Please do not  
write in  
this marginPlease complete  
legibly, preferably  
in black type, or  
bold block lettering**A fee of £10 is payable to Companies House in respect of each register entry for a mortgage or charge.**

Pursuant to section 395 of the Companies Act 1985

To the Registrar of Companies  
(Address overleaf - Note 6)

For official use

Company number

2849445

Name of company

\* LINDEN HOMES SOUTH-EAST LIMITED

\* insert full name  
of Company

Date of creation of the charge

31st March 1999

Description of the instrument (if any) creating or evidencing the charge (note 2)

Legal Mortgage

Amount secured by the mortgage or charge

Two Hundred and Fifty Thousand Pounds (£250,000.00)

Names and addresses of the mortgagees or persons entitled to the charge

HYDE HOUSING ASSOCIATION LIMITED

Leegate House Burnt Ash Road London SE12 8RR

Postcode

Presentor's name address and  
reference (if any) :Sharratts (London)  
6 Queen Victoria  
Terrace  
Sovereign Court E1 9HA

Time critical reference

For official Use  
Mortgage Section

Post room



Short particulars of all the property mortgaged or charged

Part of the Freehold Land situate at East Road Reigate which is shown edged red on the plan bound within the Legal Charge.

Please do not write in this margin

Please complete legibly, preferably in black type, or bold block lettering

Particulars as to commission allowance or discount (note 3)

Nil

Signed

Date

14 APR 1999

On behalf of [company][mortgagee/chargee]†

A fee of £10 is payable to Companies House in respect of each register entry for a mortgage or charge. (See Note 5)

† delete as appropriate

Notes

- 1 The original instrument (if any) creating or evidencing the charge, together with these prescribed particulars correctly completed must be delivered to the Registrar of Companies within 21 days after the date of creation of the charge (section 395). If the property is situated and the charge was created outside the United Kingdom delivery to the Registrar must be effected within 21 days after the date on which the instrument could in due course of post, and if dispatched with due diligence, have been received in the United Kingdom (section 398). A copy of the instrument creating the charge will be accepted where the property charged is situated and the charge was created outside the United Kingdom (section 398) and in such cases the copy must be verified to be a correct copy either by the company or by the person who has delivered or sent the copy to the registrar. The verification must be signed by or on behalf of the person giving the verification and where this is given by a body corporate it must be signed by an officer of that body. A verified copy will also be accepted where section 398(4) applies (property situate in Scotland or Northern Ireland) and Form No. 398 is submitted.
- 2 A description of the instrument, eg "Trust Deed", "Debenture", "Mortgage", or "Legal charge", etc, as the case may be, should be given.
- 3 In this section there should be inserted the amount or rate per cent. of the commission, allowance or discount (if any) paid or made either directly or indirectly by the company to any person in consideration of his:
  - (a) subscribing or agreeing to subscribe, whether absolutely or conditionally, or
  - (b) procuring or agreeing to procure subscriptions, whether absolute or conditional,for any of the debentures included in this return. The rate of interest payable under the terms of the debentures should not be entered.
- 4 If any of the spaces in this form provide insufficient space the particulars must be entered on the prescribed continuation sheet.
- 5 Cheques and Postal Orders are to be made payable to **Companies House**.
- 6 The address of the Registrar of Companies is:-

A fee of £10 is payable to Companies House in respect of each register entry for a mortgage or charge.

# Legend

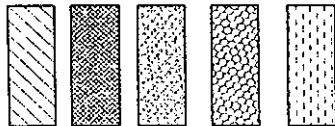

Land to be adopted by Local Authority under a Section 38 Agreement

Hard areas maintained by Management Company

Soft areas maintained by Management Company

Common Area to Shared Equity Flats

Sewer Easement

Plot number / Parking allocation

Postal numbers

Plot Boundary Ownership

Street lighting adopted by Local Authority

42/4



## CASTLE PLACE EAST ROAD / YORKE ROAD REIGATE

### CONVEYANCE PLAN

SCALE 1:500  
DATE: JAN '99

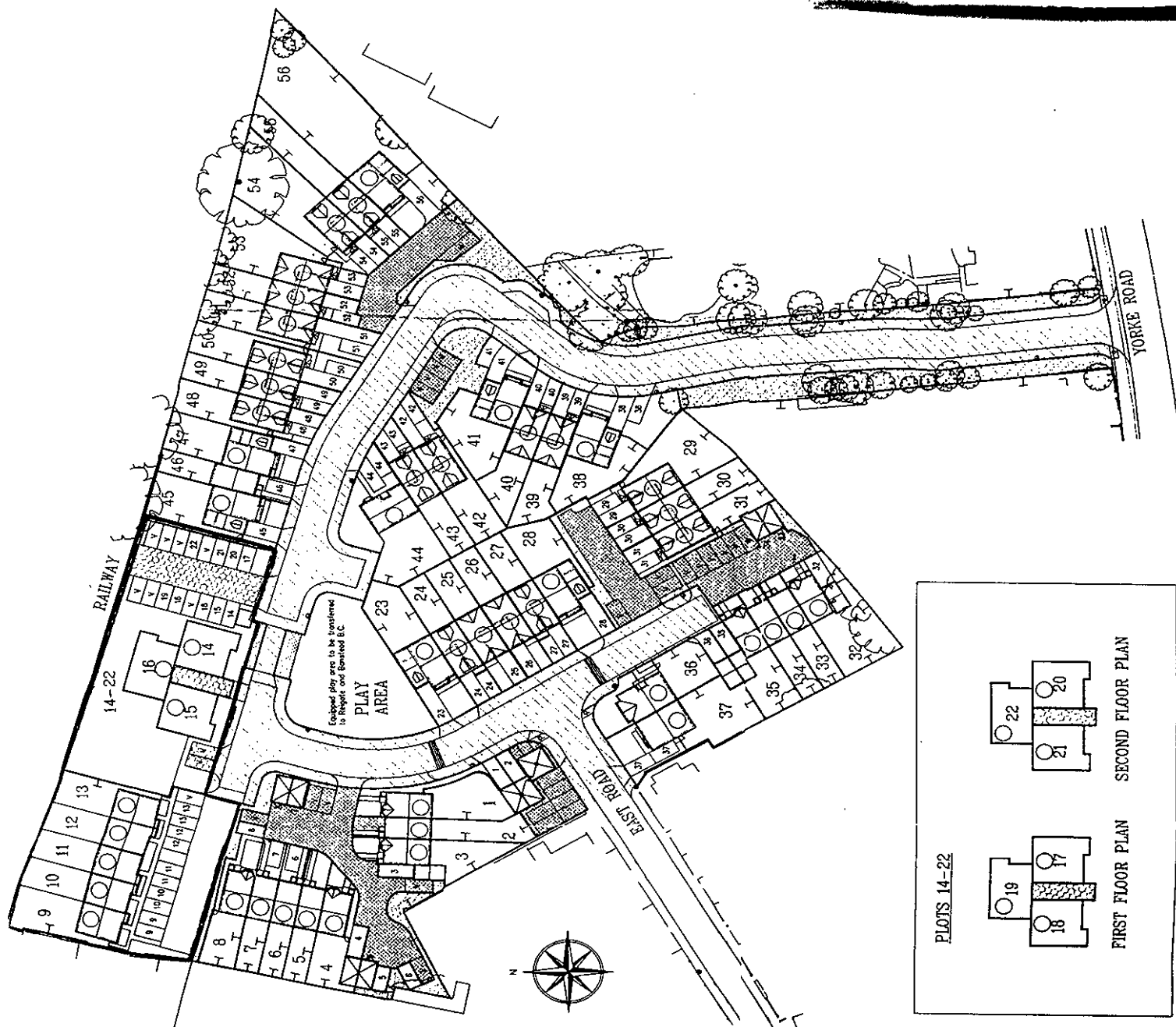

PLOTS 14-22

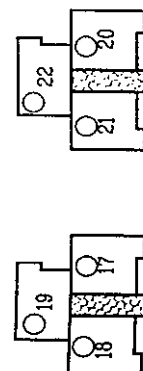

FIRST FLOOR PLAN

SECOND FLOOR PLAN

FILE COPY



## CERTIFICATE OF THE REGISTRATION OF A MORTGAGE OR CHARGE

Pursuant to section 401(2) of the Companies Act 1985

COMPANY No. 02849445

THE REGISTRAR OF COMPANIES FOR ENGLAND AND WALES HEREBY CERTIFIES THAT A LEGAL MORTGAGE DATED THE 31st MARCH 1999 AND CREATED BY LINDEN HOMES SOUTH-EAST LIMITED FOR SECURING £250,000 DUE FROM THE COMPANY TO HYDE HOUSING ASSOCIATION LIMITED WAS REGISTERED PURSUANT TO CHAPTER 1 PART XII OF THE COMPANIES ACT 1985 ON THE 15th APRIL 1999.

GIVEN AT COMPANIES HOUSE, CARDIFF THE 19th APRIL 1999.



THE OFFICIAL SEAL OF THE  
REGISTRAR OF COMPANIES



COMPANIES HOUSE

HC026B